



Certificado Nº SGI 3198065/11



Certificado Nº SGI 3198065/12

BASE SUPPORT SBL41

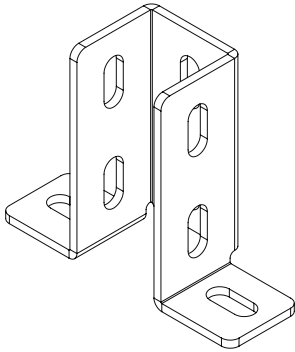

Coating: PG, HDG

Characteristics:

- Metallic
- Non-flame propagating component
- Electrically conductive component
- With metallic coating. Resistance to corrosion:

PG: class 3

HDG: class 6

INSTRUCTIONS FOR USE

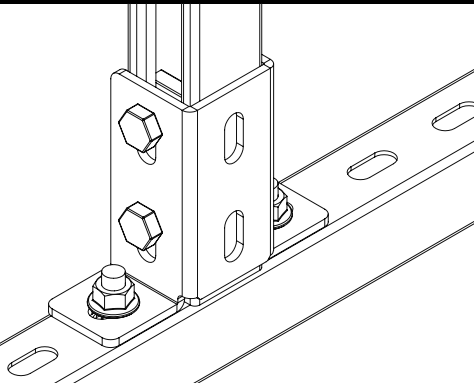

- Base support SBL41 is used to fix 41x41 strut profiles to another profiles with 2 TM41 M10 spring nuts and 2 bolts DIN933 M10X30 (open face) or 2 Sets Bolts B3 (close face). It's used to fix 41x41 strut profiles to wall, floor or ceiling too.

- To fix 41x41 strut profile to base support SBL41, two spring nuts M10 and two bolts M10x30 DIN 933 are needed.

- SBL41 is usually used with products of BASORPERFIL 41/82 family to make up rack supports, special tunnel supports, or even solar energy structures.

WORKING LOAD INFORMATION

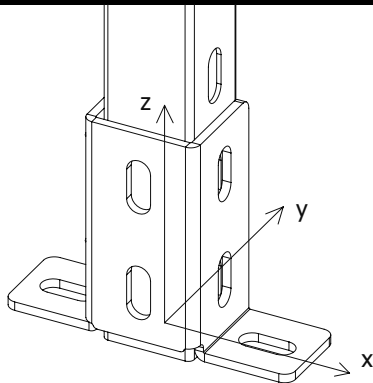

ADMISSIBLE EFFORTS			
SBL41	My	Fx	Fz
	kg.m	kg	kg
	42	490	900

Declared values include 1.7 safety factor as requested in EN IEC 61537 for cable tray supports.

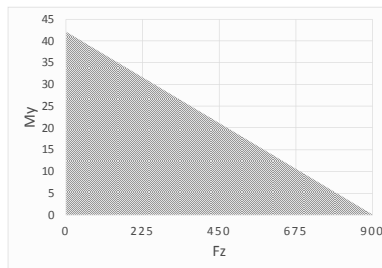

In order to check the part in a concrete application as a down / ceiling element, it will be verified that the simultaneous stresses due to the moment and the load are within the safe area of the graph.

NOTE: In the case of roof downslope, the load value will be limited to the slip value of the spring nut by the number of nuts (2x350 = 700kg).

Related products:

BASORPERFIL 41/82 profiles and accessories.